

# Cembrit Patina Signature

# CEMBRIT

Be sure to install the boards in the correct position according to plan and that they are turn correctly according to the selected pattern.

## The self-ventilating facade

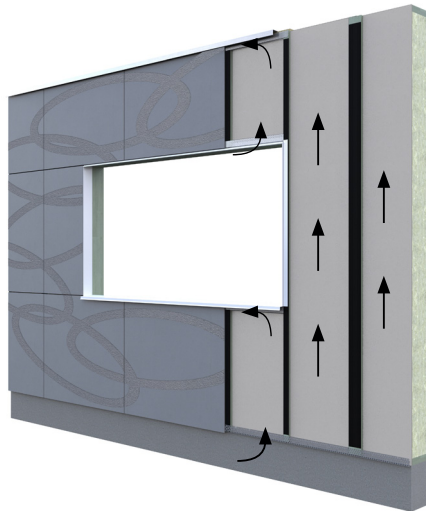

Air is pulled into the construction through an opening at the base of the facade. Unobstructed ventilation must be ensured throughout the facade's height. The ventilated area behind the boards must be at least 20mm. There must be a min. ventilation gap of 10mm or 100cm<sup>2</sup> per meter at openings.

## Screw and batten distances

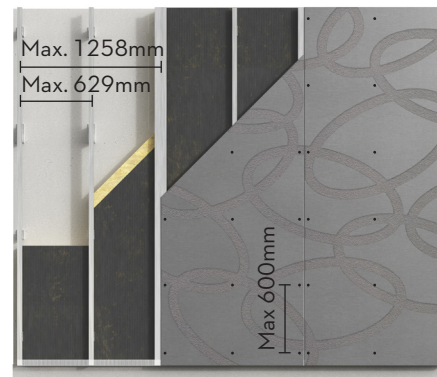

You can vary the fixing distance to make them fit better into the design. However, it still has to follow the various max and minimum distance.  
 Max. support distance: 629mm o.c.  
 Max. screw/rivet distance: 600mm o.c.  
 Max. wind load: please find the wind load table in the global Cembrit Patina installation manual found on [cembrit.com](http://cembrit.com).

## Distances on wood

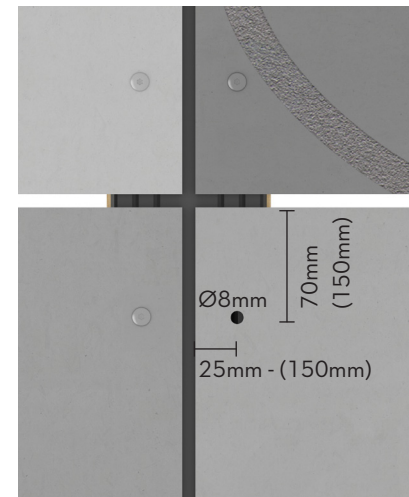

Fixing distances from the top of the board should be min. 70mm and max. 150mm. Fixing distances from the side of the board should be min. 25mm and max. 150mm.

## Distances on steel/aluminium

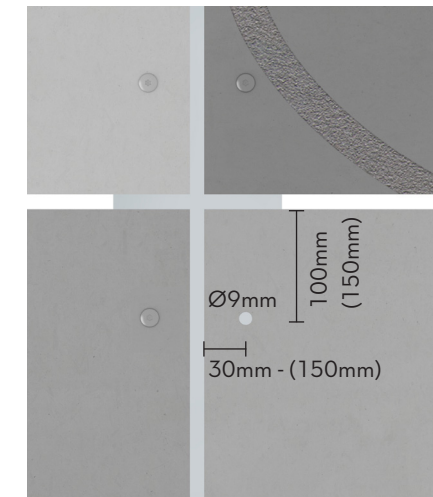

Fixing distances from the top of the board should be min. 100mm and max. 150mm. Fixing distances from the side of the board should be min. 30mm and max. 150mm.

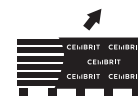
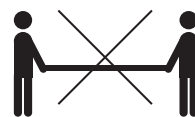
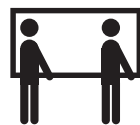

## Wood structure

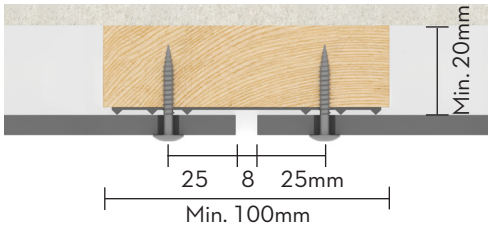

Batten width should be min. 100mm for supporting battens and 45mm for central battens. When using timber battens, always use Cembrit EPDM with profiled ribs.

Screw: pre-drilling with  $\varnothing 8\text{mm}$

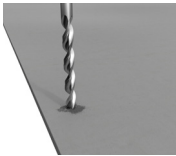

Applying Cembrit Facade Screws. Ensure that the screws are centrally located in pre-drilled holes. Please be careful not to overtighten the screw - especially near the edges and corners of the boards.



When using fixing points for wood, the hole diameter should be  $\varnothing 5\text{mm}$ .

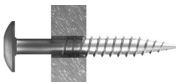

**Cembrit Facade Screw**  
SCR-W 4.5x30 /36 /41mm  
12mm head



**Cembrit Facade Wing Screw**  
SCR-W W 4.9x38mm  
12mm head



**Cembrit EPDM 3x50/100mm**



## Steel profiles

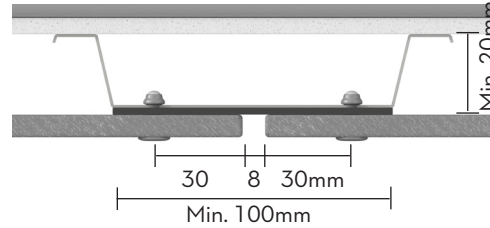

Cembrit recommends that the steel has a min. thickness of 0.7mm. The max. length of the steel profile is 3000mm. The profiles behind joints should have a min width of 100mm, and the middle profiles should have a min. width of 40mm. Always use flat EPTL/EPDM on steel profiles.

Screw: pre-drilling with  $\varnothing 8\text{mm}$   
Rivet: pre-drilling in facade board with  $\varnothing 9\text{mm}$  and in steel with  $\varnothing 4.8\text{mm}$

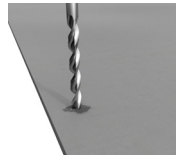

Applying Cembrit Facade Screws. Ensure that the screws are centrally located in pre-drilled holes. Please be careful not to overtighten the screw - especially near the edges and corners of the boards.



Rivet - Fixing point hole diameter  $\varnothing 9\text{mm}$ . Insert a Cembrit Fixing Sleeve in the hole before the rivet is fixed.

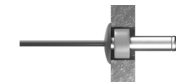

Screw - Fixing point hole diameter  $\varnothing 5\text{mm}$ .



**Cembrit Facade Screw Steel**  
SCR-S 4.8x29mm  
12mm head



**Cembrit Rivet Steel**  
4.8x20mm



## Aluminium profiles

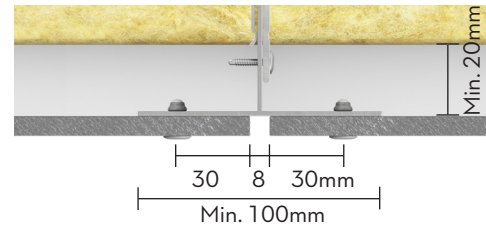

Cembrit recommends that the aluminium is of minimum 1.8mm thickness. Maximum steel profile length is 3000mm. T profiles behind joints should be min. 100mm width, and the L profiles should be min. 40mm width.

Rivet: pre-drilling in facade board with  $\varnothing 9\text{mm}$  and in aluminium with  $\varnothing 4.1\text{mm}$

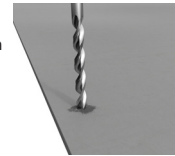

Rivet - Fixing point hole diameter  $\varnothing 9\text{mm}$ . Insert a Cembrit Fixing Sleeve in the hole before the rivet is fixed.

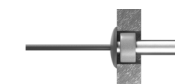

**Cembrit Rivet Steel**  
4.0x20mm



The Stand-Off Head must be used for all rivets. This provides a small space between the board and the rivet head to allow for movement caused by moisture or temperature changes.



## All

Facade boards must be installed using two fixing points\*. These should be as close to the board center as possible and must be aligned horizontally.

\*Optional for wood

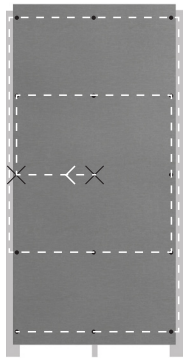

To ensure a neat finish when cutting Cembrit Patina design line boards, it is important to use the correct blade. Contact your local Cembrit office for more information. Never use water when cutting Cembrit facade boards.

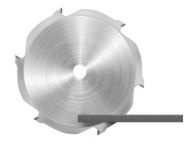

Cembrit Patina design line boards should NOT be sealed with Cembrit Edge Sealer.

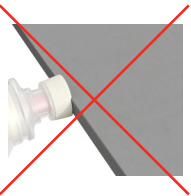

Remove dust and gravel from the board after cutting or drilling the board.

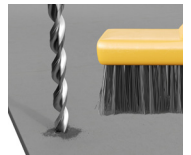

As with all building materials, safety precautions must be taken into account and local laws and regulations must be observed.



For more information go to [www.cembrit.com](http://www.cembrit.com)

# CEMBRIT